

## KETCHAM TECHNICAL DATA

### CHROME SERIES

<u>MODEL #</u>	<u>DESCRIPTION</u>
700	Toilet Paper Holder
701	Double Robe Hook
702	Soap Dish
703	Toothbrush/Tumber Holder
704	Single Robe Hook
705	Towel Ring
707	Toilet Paper Holder/Chrome Roller
718	Towel Bar 18" Square
724	Towel Bar 24" Square
730	Towel Bar 30" Square
770	Recess Toilet Paper Holder/Roll in Reserve
774-18	Towel Shelf w/Drying Rod 18"
774-24	Towel Shelf w/Drying Rod 24"

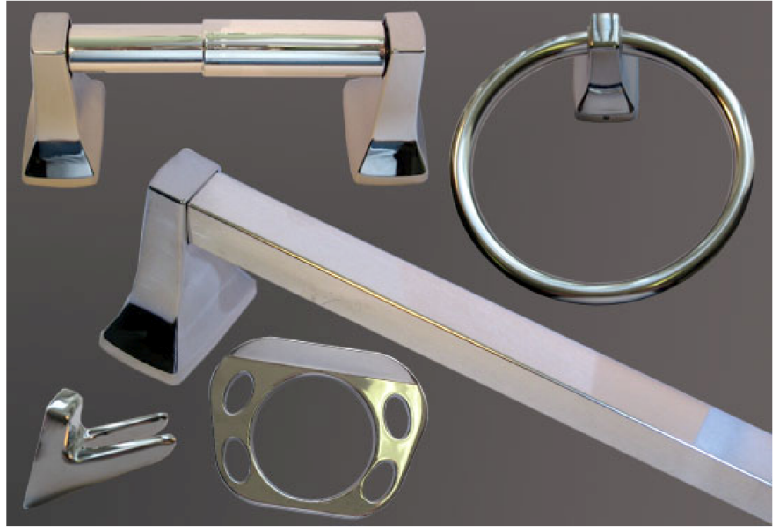

### CHROME SERIES

**Specifications:** Chrome Series Concealed Mounting accessories are fabricated of triple chrome plated rust proof zamac. Mounting hardware consists of stainless steel wall plate and stainless steel mounting screw. Unit is anchored with a set screw to lock into the stainless steel wallplate.

Ketcham Medicine Cabinets & Accessories visit our website [www.ketchamcabinets.com](http://www.ketchamcabinets.com)

877-MY-KETCHAM fax: 631-615-6155

2145 Ocean Avenue-Suite D Ronkonkoma NY 11779